

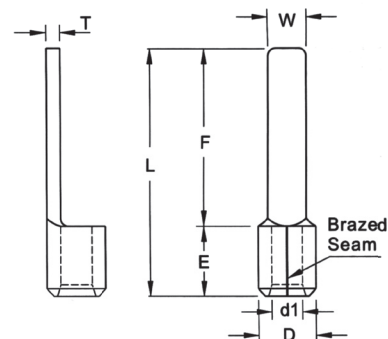

# NON-INSULATED BLADE TERMINALS



## MAXIMUM ELECTRIC CURRENT

A.W.G.	26	24	22	20	18	16	14
AMP	5.5	7	9	12	17	18	30

## TERMINAL MATERIAL COPPER

WIRE RANGE A.W.G. mm <sup>2</sup>	ITEM NO.		DIMENSION <sup>inch</sup> mm								CRIMPING TOOL	Q'TY BOX				
	BRAZED SEAM	BUTTED SEAM	W	F	L	E	D	d1	T							
26-22 A.W.G 0.2-0.5 mm <sup>2</sup>	DBNB0 5-8	DBN0 5-8	.059 1.5	.315 8.0	.472 12.0	.157 4.0	.087 2.2	.039 1.0	.020 0.5	IZUMI MODEL KSTHT 203 WITH DIE INDEX NO (INSUL)16-22	1000					
22-16 A.W.G.  0.5-1.5 mm <sup>2</sup>	DBNB1-9	DBN1-9	.110 2.8	.354 9.0	.543 13.8	.189 4.8	.134 3.4	.067 1.7	.030 0.75	IZUMI MODEL <b>5N18</b> WITH DIE INDEX NO:1.25  OR K.S. MODEL <b>KST2000D-1322</b> LY-2045A WITH DIE INDEX NO:1.25	1000					
	DBNB1-10	DBN1-10	.091 2.3	.394 10.0	.583 14.8						1000					
	DBNB1-11	DBN1-11	.118 3.0	.433 11.0	.622 15.8						1000					
	DBNB1-13	DBN1-13	.118 3.0	.512 13.0	.701 17.8						1000					
	DBNB1-14	DBN1-14	.118 3.0	.551 14.0	.740 18.8						1000					
	DBNB1-18	DBN1-18	.087 2.2	.709 18.0	.898 22.8						1000					
	DBNBS1-18	DBNS1-18	.079 2.0								1000					
16-14 A.W.G  1.5-2.5 mm <sup>2</sup>	DBNB2-9	DBN2-9	.110 2.8	.354 9.0	.543 13.8	.189 4.8	.161 4.1	.091 2.3	.031 0.8	IZUMI MODEL <b>5N18</b> WITH DIE INDEX NO 2  OR K.S. MODEL <b>KST2000D-1322</b> LY 2045A WITH DIE INDEX NO 2	1000					
	DBNB2-10	DBN2-10	.094 2.4	.394 10.0	.583 14.8						1000					
	DBNB2-13	DBN2-13	.094 2.4	.512 13.0	.701 17.8						1000					
	DBNBL2-13	DBNLL2-13	.118 3.0		.709 18.0						1000					
	DBNBLL2-13	DBNLL2-13	.177 4.5	.740 18.8							1000					
	DBNBS2-14	DBNS2-14	.083 2.1								.551 14.0	1000				
	DBNB2-14	DBN2-14	.094 2.4									1000				
	DBNBL2-14	DBNLL2-14	.118 3.0	.898 22.8								1000				
	DBNBS2-18	DBNS2-18	.079 2.0								.709 18.0	1000				
	DBNB2-18	DBN2-18	.087 2.2									1000				
	DBNBL2-18	DBNLL2-18	.110 2.8	1000												



ALL LISTED

© NOT UL AND C-UL LISTED



## NON-INSULATED BLADE TERMINALS

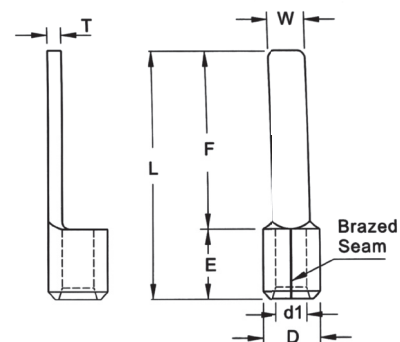

### MAXIMUM ELECTRIC CURRENT

A.W.G.	12	10
AMP	35	50

### TERMINAL MATERIAL COPPER

WIRE RANGE A.W.G. mm <sup>2</sup>	ITEM NO.		DIMENSION <sup>inch</sup> mm							CRIMPING TOOL	Q'TY BOX
	BRAZED SEAM	BUTTED SEAM	W	F	L	E	D	d1	T		
12-10 A.W.G.  4-6 mm <sup>2</sup>	DBNB5-10	DBN5-10	.110 2.8	.394 10.0	.630 16.0	.236 6.0	.220 5.6	.134 3.4	.039 1.0	IZUMI MODEL <b>5N18</b> WITH DIE INDEX NO:5.5  OR  K.S. MODEL <b>KST2000D-1322</b> LY-2045A WITH DIE INDEX NO:5.5	1000
	DBNBS5-14	DBNS5-14	.157 4.0	.551 14.0	.787 20.0						500
	DBNB5-14	DBN5-14	.177 4.5								500
	DBNBS5-18	DBNS5-18	.079 2.0	.709 18.0	.945 24.0		.228 5.8	.142 3.6			500
	DBNB5-18	DBN5-18	.177 4.5				.220 5.6	.134 3.4			500

UL cUL ALL LISTED