



## NYLON-INSULATED FLAG FEMALE DISCONNECTORS (NORMAL TYPE)

**MAXIMUM ELECTRIC CURRENT:**

A.W.G.	22	20	18	16	14	12	10
AMP.	3	4	7	10	15	20	24

**MAXIMUM ELECTRICAL RATING :** 105°C 300 VOLTS MAX.

**INSULATION MATERIAL:** NYLON

**INSULATION COLOR :**

22-18 A.W.G.: RED

16-14 A.W.G.: BLUE

12-10 A.W.G.: YELLOW

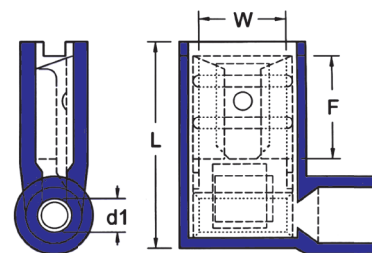
**TERMINAL MATERIAL:** BRASS

ALL LISTED

WIRE RANGE A.W.G. mm <sup>2</sup>	ITEM NO.	NEMA TAB	DIMENSION <sup>inch</sup> mm					CRIMPING TOOL	Q'TY BOX
			W	F	L	d1	T		
22-18 A.W.G. 0.5-0.75 mm <sup>2</sup>	FLDNY1-250	.032 x .250 (0.8 x 6.35)	.260 6.6	.299 7.6	.630 16.0	.067 1.7	.016 0.4	K.S. MODEL <b>KST2000F</b> WITH DIE INDEX COLOR: RED	1000
16-14 A.W.G. 1.5-2.5 mm <sup>2</sup>	FLDNY2-250	.032 x .250 (0.8 x 6.35)	.260 6.6	.299 7.6	.630 16.0	.091 2.3	.016 0.4	K.S. MODEL <b>KST2000F</b> WITH DIE INDEX COLOR: BLUE	1000
12-10 A.W.G. 4-6 mm <sup>2</sup>	FLDNY5-250	.032 x .250 (0.8 x 6.35)							

## NON-INSULATED FLAG FEMALE DISCONNECTORS (NORMAL TYPE)

**MAXIMUM ELECTRIC CURRENT:**

A.W.G.	22	20	18	16	14	12	10
AMP.	3	4	7	10	15	20	24

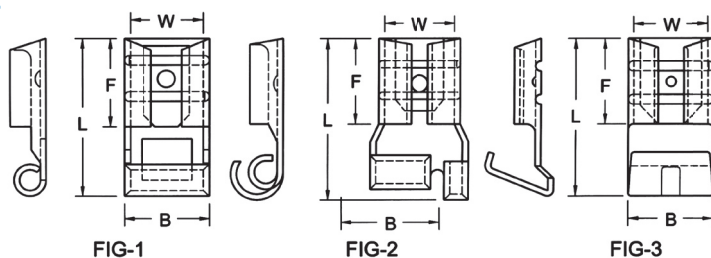
**TERMINAL MATERIAL:** BRASS

WIRE RANGE A.W.G. mm <sup>2</sup>	ITEM NO.	NEMA TAB	DIMENSION <sup>inch</sup> mm					FIG	CRIMPING TOOL	Q'TY BOX
			W	F	L	B	T			
22-18 A.W.G. 0.5-0.75 mm <sup>2</sup>	FLDNB1-187(5)	.020 x .187 (0.5 x 4.75)	.197 5.0	.244 6.2	.445 11.3	.217 5.5	.016 0.4	1		1000
	FLDNB1-187(8)	.032 x .187 (0.8 x 4.75)						1		1000
	FLDNB1-250	.032 x .250 (0.8 x 6.35)	.260 6.6	.299 7.6	.551 14.0	.291 7.4	.018 0.45	1		1000
	FLDNG1-250	.032 x .250 (0.8 x 6.35)						2		1000
16-14 A.W.G. 1.5-2.5 mm <sup>2</sup>	FLDNB2-187(5)	.020 x .187 (0.5 x 4.75)	.197 5.0	.244 6.2	.457 11.6	.217 5.5	.016 0.4	1		1000
	FLDNB2-187(8)	.032 x .187 (0.8 x 4.75)						1		1000
	FLDNB2-250	.032 x .250 (0.8 x 6.35)	.260 6.6	.299 7.6	.551 14.0	.291 7.4	.018 0.45	1		1000
	FLDNG2-250	.032 x .250 (0.8 x 6.35)						2		1000
12-10 A.W.G. 4-6 mm <sup>2</sup>	FLDNB5-250	.032 x .250 (0.8 x 6.35)	.260 6.6	.299 7.6	.571 14.5	.295 7.5	.016 0.4	3		500