



# VINYL-INSULATED RING TERMINALS

**MAXIMUM ELECTRIC CURRENT :**

A.W.G.	22	20	18	16	14
AMP.	9	12	17	18	30

**MAXIMUM ELECTRICAL RATING : 75°C 600 VOLTS MAX.**
**INSULATION MATERIAL : VINYL**
**INSULATION COLOR :**

22-16 A.W.G.: RED 16-14 A.W.G.: BLUE

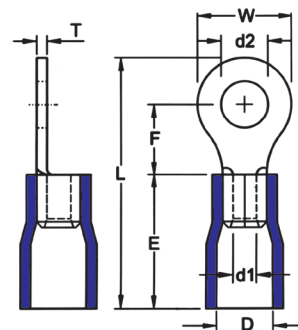
**TERMINAL MATERIAL : COPPER**

WIRE RANGE A.W.G. mm <sup>2</sup>	ITEM NO.		STUD SIZE		DIMENSION <sup>inch</sup> mm							CRIMPING TOOL	Q'TY BOX
	BRAZED SEAM	BRAZED SEAM	d2		W	F	L	E	D	d1	T		
22-16 A.W.G.          0.5-1.5 mm <sup>2</sup>	RVB1-3.2	VF1-3.2	#4	.126 3.2	.217 5.5	.197 5.0	.689 17.5					IZUMI MODEL 34 WITH DIE INDEX COLOR:RED  OR K.S. MODEL KST2000A <b>HRI-126</b> WITH DIE INDEX COLOR:RED	1000
	RVBS1-3.7	VF1-3.7S	#6	.146 3.7									1000
	RVBM1-3.7	VF1-3.7M	#6	.146 3.7	.260 6.6	.248 6.3	.764 19.4						1000
	RVBL1-3.7	VF1-3.7L	#6	.146 3.7	.315 8.0	.276 7.0	.819 20.8						1000
	RVBS1-4	VF1-4S	#8	.169 4.3	.260 6.6	.248 6.3	.764 19.4						1000
	RVBL1-4	VF1-4L	#8	.169 4.3	.315 8.0	.276 7.0	.819 20.8						1000
	RVB1-5	VF1-5	#10	.209 5.3									1000
	RVBL1-5	VF1-5L	#10	.209 5.3				.394 10.0	.157 4.0	.067 1.7	.030 0.75		1000
	RVB1-6	VF1-6	1/4	.252 6.4	.457 11.6	.433 11.0	1.055 26.8						1000
	RVB1-8	VF1-8	5/16	.331 8.4									1000
	RVB1-10	VF1-10	3/8	.413 10.5	.535 13.6	.547 13.9	1.201 30.5						1000
	RVB1-12	VF1-12	1/2	.512 13.0	.756 19.2	.630 16.0	1.394 35.4						1000
	RVB1-14	VF1-14	9/16	.591 15.0									1000
	RVB1-16	VF1-16	5/8	.669 17.0	1.063 27.0	.827 21.0	1.744 44.3				.031 0.8		1000
	RVB1-20	VF1-20	3/4	.827 21.0									1000
16-14 A.W.G.       1.5-2.5 mm <sup>2</sup>	RVB2-3.2	VF2-3.2	#4	.126 3.2		.189 4.8	.701 17.8					IZUMI MODEL 34 WITH DIE INDEX COLOR:BLUE  OR K.S. MODEL KST2000A <b>HRI-126</b> WITH DIE INDEX COLOR:BLUE	1000
	RVBS2-3.7	VF2-3.7S	#6	.146 3.7	.260 6.6								1000
	RVBM2-3.7	VF2-3.7M	#6	.146 3.7		.248 6.3	.764 19.4						1000
	RVBL2-3.7	VF2-3.7L	#6	.146 3.7	.335 8.5	.291 7.4	.858 21.8						1000
	RVBS2-4	VF2-4S	#8	.169 4.3	.260 6.6	.248 6.3	.764 19.4	.394 10.0	.177 4.5	.091 2.3	.031 0.8		1000
	RVBL2-4	VF2-4L	#8	.169 4.3									1000
	RVBS2-5	VF2-5S	#10	.209 5.3	.335 8.5	.307 7.8	.858 21.8						1000
	RVBL2-5	VF2-5L	#10	.209 5.3	.374 9.5	.287 7.3							1000



ALL LISTED

\*:ADDITIONAL CERTIFIED



# VINYL-INSULATED RING TERMINALS

**MAXIMUM ELECTRIC CURRENT :**

A.W.G.	16	14	12	10
AMP.	18	30	35	50

**MAXIMUM ELECTRICAL RATING : 75°C 600 VOLTS MAX.**
**INSULATION MATERIAL:** VINYL

**INSULATION COLOR :**

16-14 A.W.G.: BLUE 14-12 A.W.G.: BLACK 12-10 A.W.G.: YELLOW

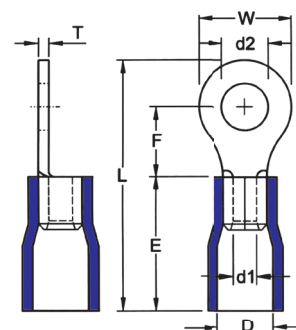
**TERMINAL MATERIAL:** COPPER

WIRE RANGE A.W.G. mm <sup>2</sup>	ITEM NO.		STUD SIZE		DIMENSION <small>inch mm</small>							CRIMPING TOOL	Q'TY BOX
	BRAZED SEAM	BRAZED SEAM	d2		W	F	L	E	D	d1	T		
16-14 A.W.G.  1.5-2.5 mm <sup>2</sup>	RVB2-6	VF2-6	1/4	.252 6.4	.472 12.0	.433 11.0	1.055 26.8					IZUMI MODEL 34 WITH DIE INDEX COLOR:BLUE  OR K.S. MODEL KST2000A <b>HRI-126</b> WITH DIE INDEX COLOR:BLUE	1000
	RVB2-8	VF2-8	5/16	.331 8.4									1000
	RVB2-10	VF2-10	3/8	.413 10.5	.535 13.6	.547 13.9	1.201 30.5						1000
	RVB2-12	VF2-12	1/2	.512 13.0	.756 19.2	.630 16.0	1.394 35.4	.394 10.0	.177 4.5	.091 2.3	.031 0.8		1000
	RVB2-14	VF2-14	9/16	.591 15.0									1000
	RVB2-16	VF2-16	5/8	.669 17.0	1.063 27.0	.827 21.0	1.744 44.3						1000
	RVB2-20	VF2-20	3/4	.827 21.0									1000
14-12 A.W.G.  2.5-4 mm <sup>2</sup>	RVB3-4	VF3-4	#8	.169 4.3	.315 8.0	.315 8.0	.984 25.0					IZUMI MODEL 214 WITH DIE INDEX COLOR:BLACK  OR K.S. MODEL KST2000A <b>HRI-126</b> WITH DIE INDEX COLOR:BLACK	1000
	RVBS3-5	VF3-5S	#10	.209 5.3				.512 13.0	.248 6.3	.118 3.0	.039 1.0		1000
	RVBL3-5	VF3-5L	#10	.209 5.3	.472 12.0	.370 9.4	1.118 28.4						1000
	RVB3-6	VF3-6	1/4	.252 6.4									1000
12-10 A.W.G.  4-6 mm <sup>2</sup>	RVB5-3.7	VF5-3.7	#6	.146 3.7								IZUMI MODEL 5 WITH DIE INDEX COLOR:YELLOW  OR K.S. MODEL KST2000A <b>HRI-126</b> WITH DIE INDEX COLOR:YELLOW	500
	RVBS5-4	VF5-4S	#8	.169 4.3	.283 7.2	.240 6.1	.894 22.7						500
	RVBL5-4	VF5-4L	#8	.169 4.3									500
	RVB5-5	VF5-5	#10	.209 5.3	.374 9.5	.327 8.3	1.024 26.0						500
	RVB5-6	VF5-6	1/4	.252 6.4	.472 12.0	.413 10.5	1.161 29.5						500
	RVBM5-6	VF5-6M	1/4	.252 6.4		.512 13.0	1.260 32.0	.512 13.0	.252 6.4	.134 3.4	.039 1.0		500
	RVB5-8	VF5-8	5/16	.331 8.4	.591 15.0	.524 13.3	1.339 34.0						500
	RVB5-10	VF5-10	3/8	.413 10.5									500
	RVB5-12	VF5-12	1/2	.512 13.0	.756 19.2	.630 16.0	1.520 38.6						500
	RVB5-14	VF5-14	9/16	.591 15.0									500
	RVB5-16	VF5-16	5/8	.669 17.0	1.260 32.0	.992 25.2	2.134 54.2						500
	RVB5-20	VF5-20	3/4	.827 21.0									500



ALL LISTED

\*: ADDITIONAL CERTIFIED