



Technical drawing of a U-bulb. The drawing shows a side view and a top view. The side view shows a vertical stem of thickness  $T$  and a bulb of length  $L$ . The bulb has a vertical section of height  $F$  and a horizontal section of height  $E$ . The top view shows a U-shaped bulb with a width  $W$  and a diameter  $d2$ . The stem has a diameter  $d1$ . A label "Braze Seam" points to the joint between the stem and the bulb. A cross symbol is located in the center of the bulb's U-shape.

A.W.G.	22	20	18	16	14
AMP	9	12	17	18	30

WIRE RANGE A.W.G. mm <sup>2</sup>	ITEM NO.		STUD SIZE		DIMENSION <small>inch mm</small>							CRIMPING TOOL	Q'TY BOX			
	BRAZED SEAM	BRAZED SEAM	d2		W	F	L	E	D	d1	T					
22-16 A.W.G      05-15 mm <sup>2</sup>	SNB1-3 2 *	SL1-3.2Y *	#4	126 3 2	.224 5 7	.256 6 5	.630 16 0	.189 4.8	.134 3.4	.067 1 7	.030 0 75	IZUMI MODEL <b>5N18</b> WITH DIE INDEX NO 1 25  OR K.S. MODEL <b>KST2000D-1322</b> LY 2045A LY 2045C LY 2045D WITH DIE INDEX NO 1 25	1000			
	SNBS1-3 7 *	SL1-3.7YS *	#6	146 3 7									1000			
	SNBL1-3 7 *	SL1-3.7YL *	#6	.146 3 7									.252 6 4	1000		
	SNBLL1-3 7 *	SL1-3.7YLL *	#6	146 3 7									.283 7.2	1000		
	SNBS1-4 *	SL1-4YS *	#8	169 4 3									.252 6 4	1000		
	SNBM1-4 *	SL1-4YM *	#8	169 4 3									.283 7.2	1000		
	SNBL1-4 *	SL1-4YL *	#8	169 4 3									.319 8 1	1000		
	SNBS1-5 *	SL1-5YS *	#10	209 5 3										1000		
	SNBL1-5 *	SL1-5Y *	#10	209 5 3										.374 9.5	1000	
	SNBS1-6 *	SL1-6YS *	1/4	252 6 4									1000			
SNBL1-6 *	SL1-6Y *	1/4	252 6 4	.472 12 0	.433 11 0	.866 22 0	1000									
16-14 A.W.G.      1.5-2.5 mm <sup>2</sup>	SNB2-3.2 *	SL2-3.2Y *	#4	.126 3.2	.224 5.7	.256 6.5	.630 16.0	.189 4.8	.161 4.1	.091 2.3	.031 0.8	IZUMI MODEL <b>5N18</b> WITH DIE INDEX NO:2  OR K.S. MODEL <b>KST2000D-1322</b> LY-2045A LY-2045C LY-2045D WITH DIE INDEX NO:2	1000			
	SNBS2-3.7 *	SL2-3.7YS *	#6	.146 3.7									1000			
	SNBL2-3.7 *	SL2-3.7YL *	#6	.146 3.7									.236 6.0	1000		
	SNBLL2-3.7 *	SL2-3.7YLL *	#6	.146 3.7									.283 7.2	1000		
	SNBS2-4 *	SL2-4YS *	#8	.169 4.3									.252 6.4	1000		
	SNBM2-4 *	SL2-4YM *	#8	.169 4.3									.283 7.2	1000		
	SNBL2-4 *	SL2-4YL *	#8	.169 4.3									.319 8.1	1000		
	SNBS2-5 *	SL2-5YS *	#10	.209 5.3										1000		
	SNBL2-5 *	SL2-5Y *	#10	.209 5.3										.366 9.3	1000	
	SNBS2-6 *	SL2-6YS *	1/4	.252 6.4									1000			
	SNBL2-6 *	SL2-6Y *	1/4	.252 6.4									.472 12.0		.433 11.0	.866 22.0

16



# NON-INSULATED SPADE TERMINALS

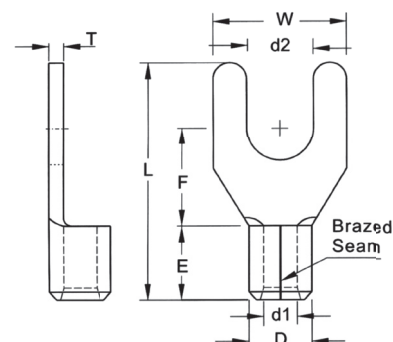

## MAXIMUM ELECTRIC CURRENT

A.W.G.	14	12	10	8	6
AMP	30	35	50	70	95

TERMINAL MATERIAL COPPER

WIRE RANGE A.W.G. mm <sup>2</sup>	ITEM NO.		STUD SIZE		DIMENSION <sup>inch</sup> mm							CRIMPING TOOL	Q'TY BOX
	BRAZED SEAM	BRAZED SEAM	d2		W	F	L	E	D	d1	T		
14-12 A.W.G.  2.5-4 mm <sup>2</sup>	SNB3-3 7	SL3-3.7Y	#6	.146 3.7								IZUMI MODEL <b>5N18</b> WITH DIE INDEX NO:5.5 OR K.S. MODEL <b>KST2000D-1322</b> LY-2045A LY-2045C LY-2045D WITH DIE INDEX NO:5.5	1000
	SNB3-4	SL3-4Y	#8	.169 4.3	.315 8.0	.276 7.0	.720 18.3						1000
	SNB3-5	SL3-5Y	#10	.209 5.3				.236 6.0	.197 5.0	.118 3.0	.039 1.0		1000
	SNB3-6	SL3-6Y	1/4	.252 6.4	.472 12.0	.358 9.1	.846 21.5						1000
12-10 A.W.G.  4-6 mm <sup>2</sup>	SNBS5-3.7	SL5-3.7YS	#6	.146 3.7	.283 7.2	.295 7.5	.685 17.4					IZUMI MODEL <b>5N18</b> WITH DIE INDEX NO:5.5 OR K.S. MODEL <b>KST2000D-1322</b> LY-2045A LY-2045C LY-2045D WITH DIE INDEX NO:5.5	1000
	SNB5-3.7 *	SL5-3.7Y *	#6	.146 3.7	.327 8.3	.276 7.0	.728 18.5						1000
	SNBSS5-4	SL5-4YSS	#8	.169 4.3	.283 7.2	.295 7.5	.685 17.4						1000
	SNBS5-4 *	SL5-4YS *	#8	.169 4.3	.327 8.3								1000
	SNBL5-4 *	SL5-4Y *	#8	.169 4.3		.276 7.0	.720 18.3	.236 6.0	.220 5.6	.134 3.4	.039 1.0		1000
	SNB5-5 *	SL5-5Y *	#10	.209 5.3	.354 9.0								1000
	SNBS5-6 *	SL5-6YS *	1/4	.252 6.4									1000
	SNBL5-6 *	SL5-6Y *	1/4	.252 6.4	.472 12.0	.472 12.0	.965 24.5						1000
	SNB5-8	SL5-8Y	5/16	.331 8.4	.551 14.0	.413 10.5	.925 23.5						1000
8 A.W.G.  8 mm <sup>2</sup>	SNB8-5	SL8-5Y	#10	.209 5.3	.413 10.5	.319 8.1	.819 20.8					IZUMI MODEL <b>5N18</b> WITH DIE INDEX NO 8 OR K.S. MODEL <b>KST2000D-1322</b>	500
	SNB8-6	SL8-6Y	1/4	.252 6.4	.425 10.8	.339 8.6	.886 22.5	.335 8.5	.283 7.2	.177 4.5	.047 1.2		500
6 A.W.G.  14 mm <sup>2</sup>	SNB14-6	SL14-6Y	1/4	.252 6.4	.433 11.0	.421 10.7	1.004 25.5					IZUMI MODEL <b>9H-60</b> WITH DIE INDEX NO:14 OR K.S. MODEL LY-2045B WITH DIE INDEX NO:14	500
	SNB14-8	SL14-8Y	5/16	.331 8.4	.543 13.8	.421 10.7	1.122 28.5	.413 10.5	.354 9.0	.228 5.8	.059 1.5		500

ALL LISTED  
 \* ADDITIONAL CERTIFIED